

**KEY**  
 — PROPOSED  
 — NO WAITING AT ANY TIME  
 — EXISTING WAITING AND  
 — PARKING RESTRICTIONS

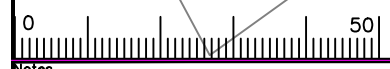

Notes

Rev.	Description	Drwn	Sig.	Date	Chkd	Sig.	Date	Appr	Sig.	Date
A	RESTRICTIONS ADDED	CAH	CAH	02.10	JP	JP	02.10	TPC	TPC	02.10

Drwn	Sig.	Date	Chkd	Sig.	Date	Appr	Sig.	Date
CAH	CAH	02.10	JP	JP	02.10	TPC	TPC	02.10

North Point

Drawn by	Sig.	Date
CAH	CAH	02.10
Checked by originator	Sig.	Date
JP	JP	02.10
Approved by	Sig.	Date
TPC	TPC	02.10

Project  
**REIGATE AND BANSTEAD DPE  
 BANSTEAD**  
 Drawing  
**IMPLEMENTED TRAFFIC ORDERS**

**SURREY**  
 COUNTY COUNCIL  
 Sustainable Development

Project No. 3282/R&B	Contract Sheet No.	Rev. A
Drawing No. 18007	Classification ADVERTISED	

SHEET OF

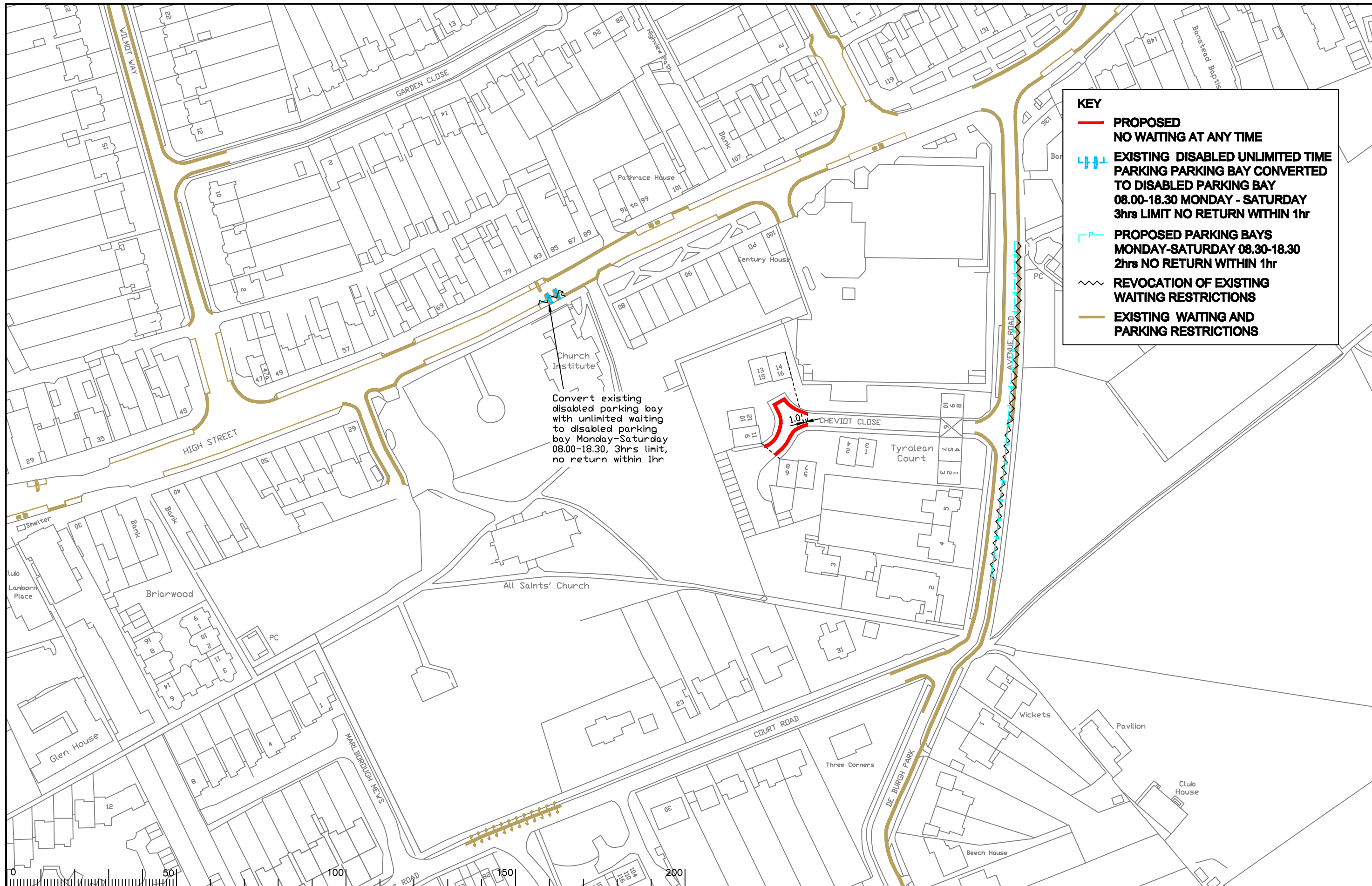

**KEY**

- **PROPOSED NO WAITING AT ANY TIME**
- ▨ **EXISTING DISABLED UNLIMITED TIME PARKING BAY CONVERTED TO DISABLED PARKING BAY 08.00-18.30 MONDAY - SATURDAY 3hrs LIMIT NO RETURN WITHIN 1hr**
- **PROPOSED PARKING BAYS MONDAY-SATURDAY 08.30-18.30 2hrs NO RETURN WITHIN 1hr**
- ~ **REVOCAION OF EXISTING WAITING RESTRICTIONS**
- **EXISTING WAITING AND PARKING RESTRICTIONS**

Convert existing disabled parking bay with unlimited waiting to disabled parking bay Monday-Saturday 08.00-18.30, 3hrs limit, no return within 1hr

1.0m

Notes

0	50	100	150	200
---	----	-----	-----	-----

Rev.	Description	Drwn	Sig.	Date	Chkd	Sig.	Date	Appr	Sig.	Date
A	RESTRICTIONS AND DISABLED BAYS ADDED	CAH	CAH	02.10	JP	JP	02.10	TPC	TPC	02.10
B	RESTRICTIONS AMENDED - JUNE COMMITTEE	CAH	CAH	05.10	JP	JP	05.10	TPC	TPC	05.10

North Point

Based upon the Ordnance Survey mapping with the permission of the Controller of Her Majesty's Stationary Office © Crown copyright. Unauthorised reproduction infringes Crown copyright and may lead to prosecution or civil proceedings. Surrey County Council LA 078872 1998.

Drawn by	CAH	Sig.	CAH	Date	02.10
Checked by originator	JP	Sig.	JP	Date	02.10
Approved by	TPC	Sig.	TPC	Date	02.10

Project

**REIGATE AND BANSTEAD DPE BANSTEAD**

**IMPLEMENTED TRAFFIC ORDERS**

Drawing

Project No. 3282/R&B

Contract Sheet No. 18009

Rev. B

Classification ADVERTISED

SHEET OF



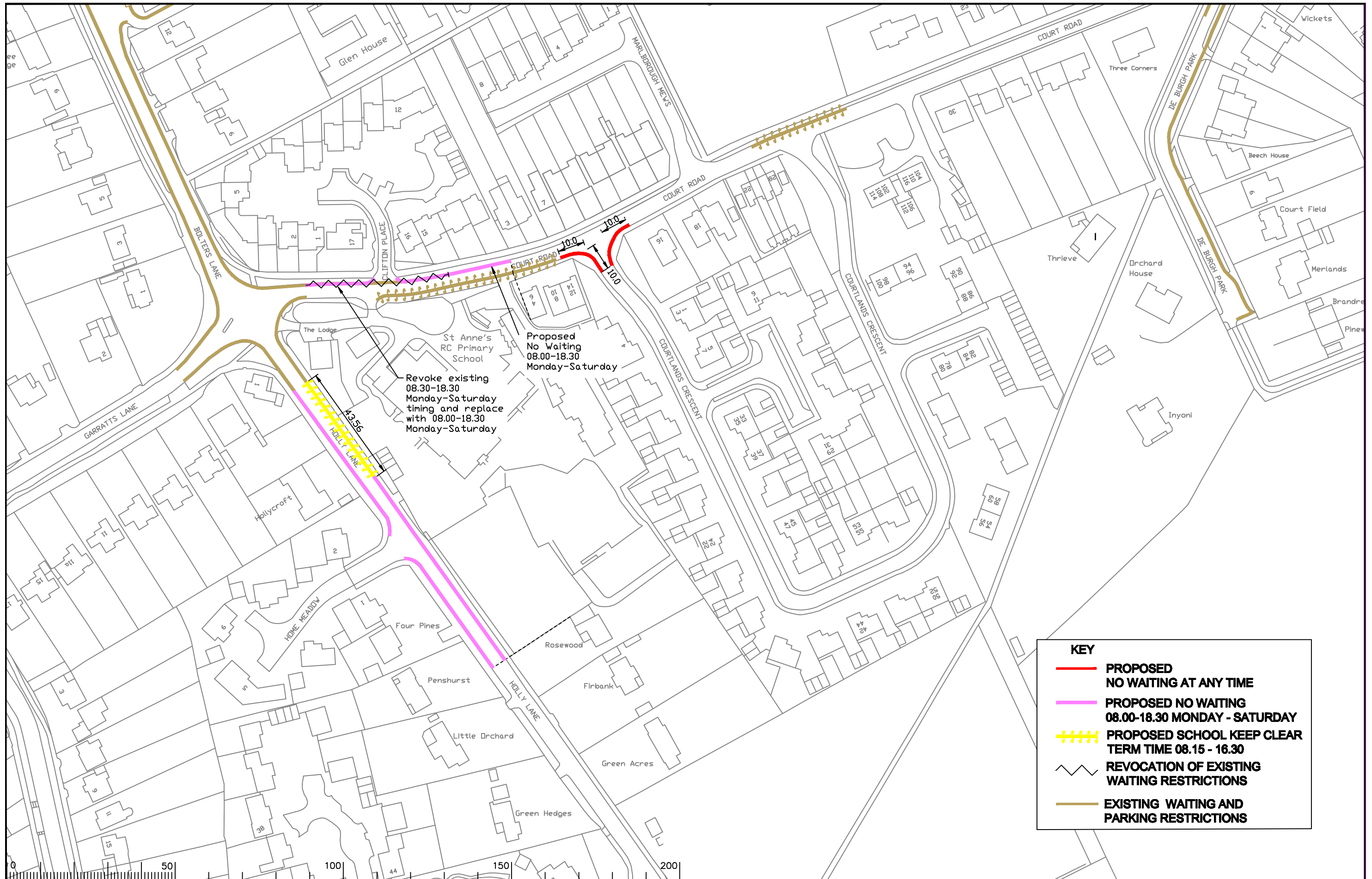

Proposed  
No Waiting  
08.00-18.30  
Monday-Saturday

Revoke existing  
08.30-18.30  
Monday-Saturday  
timing and replace  
with 08.00-18.30  
Monday-Saturday

**KEY**

- **PROPOSED NO WAITING AT ANY TIME**
- **PROPOSED NO WAITING 08.00-18.30 MONDAY - SATURDAY**
- - - - **PROPOSED SCHOOL KEEP CLEAR TERM TIME 08.15 - 16.30**
- ~ ~ ~ ~ **REVOCAION OF EXISTING WAITING RESTRICTIONS**
- **EXISTING WAITING AND PARKING RESTRICTIONS**

Notes

Rev.	Description	Drwn	Sig.	Date	Chkd	Sig.	Date	Appr	Sig.	Date
A	RESTRICTIONS REVOKED AND ADDED	CAH	CAH	02.10	JP	JP	02.10	TPC	TPC	02.10
B	RESTRICTIONS AMENDED - JUNE COMMITTEE	CAH	CAH	05.10	JP	JP	05.10	TPC	TPC	05.10

Drwn	Sig.	Date	Chkd	Sig.	Date	Appr	Sig.	Date
CAH	CAH	02.10	JP	JP	02.10	TPC	TPC	02.10
CAH	CAH	05.10	JP	JP	05.10	TPC	TPC	05.10

North Point

Based upon the Ordnance Survey mapping with the permission of the Controller of Her Majesty's Stationary Office © Crown copyright. Unauthorised reproduction infringes Crown copyright and may lead to prosecution or civil proceedings. Surrey County Council LA 078872 1996.

Drawn by	Sig.	Date
CAH	CAH	02.10
Checked by originator	Sig.	Date
JP	JP	02.10
Approved by	Sig.	Date
TPC	TPC	02.10

Project  
**REIGATE AND BANSTEAD DPE  
BANSTEAD**

Drawing  
**IMPLEMENTED TRAFFIC ORDERS**

SHEET OF

Project No.  
3282/R&B

Contract Sheet No.  
18010

Rev.  
B

Classification  
ADVERTISED

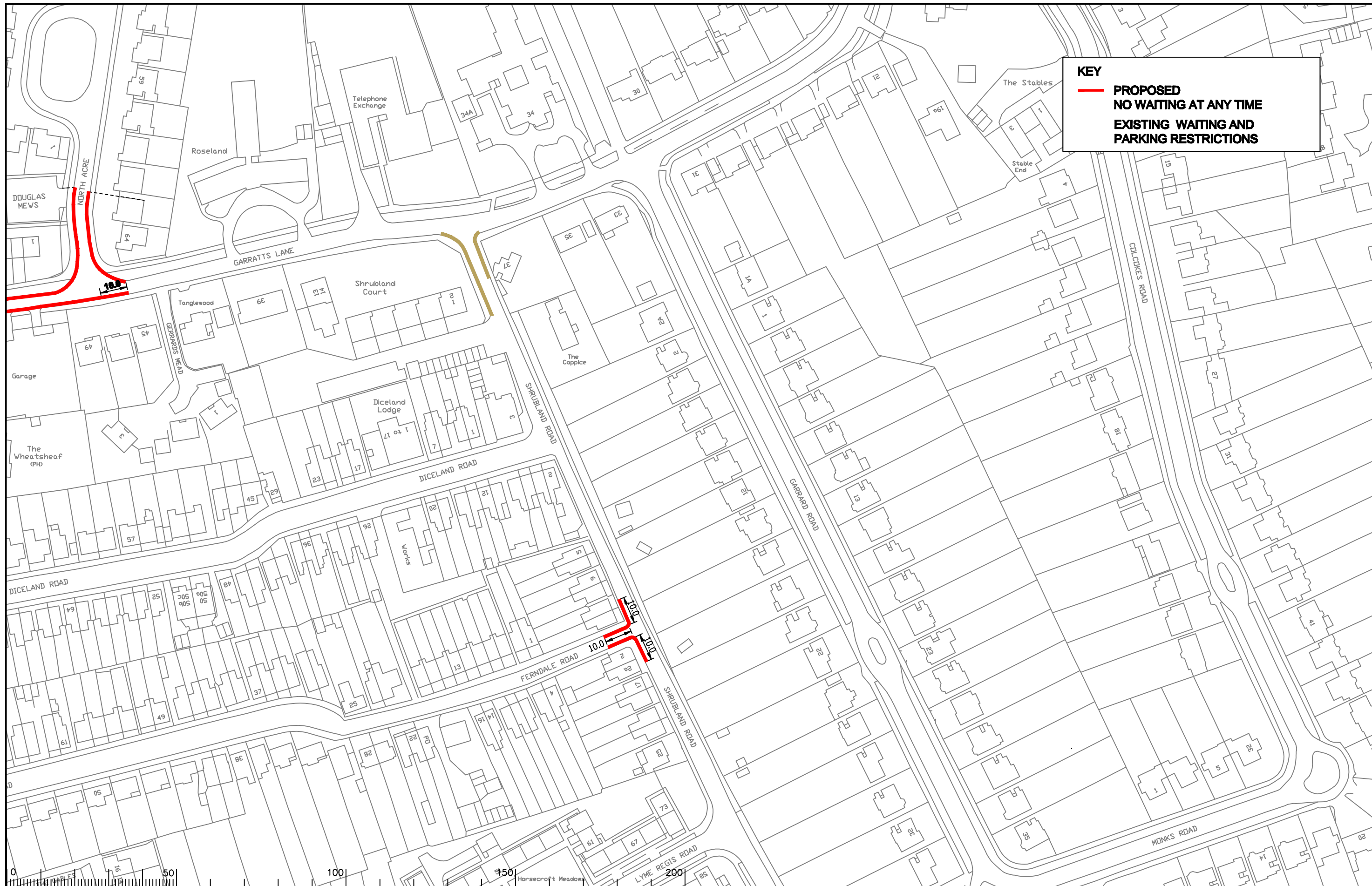

**KEY**

— **PROPOSED  
NO WAITING AT ANY TIME**

— **EXISTING WAITING AND  
PARKING RESTRICTIONS**

Notes

0 50 100 150 200

Rev.	Description	Drwn	Sig.	Date	Chkd	Sig.	Date	Appr	Sig.	Date
A	RESTRICTIONS ADDED	CAH	CAH	02.10	JP	JP	02.10	TPC	TPC	02.10

North Point

Based upon the Ordnance Survey mapping with the permission of the Controller of Her Majesty's Stationery Office © Crown copyright. Unauthorised reproduction infringes Crown copyright and may lead to prosecution or civil proceedings. Surrey County Council LA 078872 1996.

Drawn by	Sig.	Date
CAH	CAH	02.10
Checked by originator	Sig.	Date
JP	JP	02.10
Approved by	Sig.	Date
TPC	TPC	02.10

Project

**REIGATE AND BANSTEAD DPE  
BANSTEAD**

Drawing

**IMPLEMENTED TRAFFIC ORDERS**

SHEET OF

Project No. 3282/R&B

Contract Sheet No. 18011

Rev. A

Classification ADVERTISED